

PARAMOUNT
THIN STONE

For questions,
problems, or more
information, please
call (203) 353-9119

Safety Equipment

- Safety glasses (clear)
- Dust mask
- Ear plugs
- Work gloves

Tools

- Brush
- Carpenter's level
- Chalk line
- Diamond blade masonry saw
- Grout bag
- Masonry hammer
- Margin trowel
- Mason's trowel
- Nail and/or staple gun
- Notched trowel
- Pencil
- Tape measure
- Tuck pointer
- Wheel barrow or cement mixer
- Whisk broom

Materials

- PARAMOUNT THINSTONE™ flats
- PARAMOUNT THINSTONE™ pre-cut corners
- Type-S mortar (ASTM c270)
- Dry masonry sand
- Acrylic bonding agent (for mortar mix)
- Clean water

PART I : OVERVIEW & PREPARATION

Preparation of Work Area

- Protect floors, trim and any areas that could be damaged during installation.
- Layout material close to installation area so that stones can be reached and easily viewed. Be sure to select stone from multiple shipping containers and organize by size, color, shape and texture to ensure a consistent finish.
- Install stone veneer between 60°-80°F. **Mortar will NOT properly bond < 40°F or >120°F.**

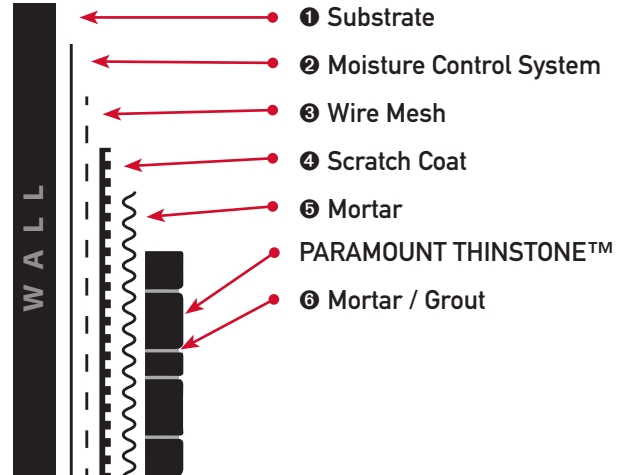

① Substrate

- Wood studs with rigid 0.5 in sheathing.
- Metal studs with rigid 0.5 in sheathing.
- Poured Concrete.
- Block Concrete.
- **Do NOT install rigid insulation.**

② Moisture Control System

- Helps prevent efflorescence (white deposits on stone face) and protects rigid sheathing from water damage.
- Use for all exterior applications.
- Use for all wet interior applications such as water features, pools, showers or spas.
- **NOT required for interior dry areas.**

③ Wire Mesh or Metal Lath

- Use expanded galvanized, diamond-mesh meeting requirements of ASTM C847-07, minimum of 2.5 lb/yd²
- Install tightly and overlap sections approximately 1 inch.
- Install rough side out and upward. Check by passing your fingers from top to bottom, it should feel rough.
- Fasten every 16 inches horizontally on center and a minimum of every 6 inches vertically.
- Wrap inside and outside corners a minimum of 16 inches.
- If anchoring to wood studs use wide-crown staples and penetrate at least 1 inch deep.
- If anchoring to metal studs penetrate at least 0.5 inch beyond inside surface.
- **NOT required for concrete substrates.**

④ Scratch Coat

- Surface must be clean and free of debris.
- Use Type-S mortar
- **DO NOT** leave scratch coat smooth. Groove horizontally with a notched trowel.

⑤ Mortar

- Type-S (ASTM C270) should be used.
- Mortar should stick to the trowel if it is the correct consistency. Ensure that it is not too wet or too dry.
- Add acrylic bonding agent to Type-S mortar to enhance the flexural, adhesive, compressive and tensile strength.

⑥ Trimming and Field Dressing

- Be sure to use safety gear.
- Use a diamond blade masonry saw and grinder to shape the stone to fit.
- A masonry hammer can also be used to custom fit and trim stone as required.

**PLEASE USE THE PROPER
SAFETY EQUIPMENT!**



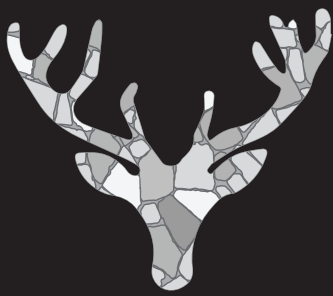

PARAMOUNT
THIN STONE

For questions,
problems, or more
information, please
call (203) 353-9119

Flats

Calculate the total area to be covered in square feet.

Multiply the LENGTH (in feet) by the HEIGHT (in feet).

Length x Height = Area

EXAMPLE

5 ft x 20 ft = 100 ft²

Pallet Sizes

- 20 sqft
- 50 sqft
- 100 sqft
- 200 sqft

Corners

Calculate the length of the corner area in linear feet.

One linear foot will cover approximately 0.75 square feet of flats, which should be deducted from the quantity of flats needed.

EXAMPLE

If you need 10 linear feet of corners, be sure to deduct 7.5 square feet of flats from your order.

Note

Be sure to add 5% to 15% extra material, depending on the size of the project.

This will ensure a blend of color and shape, and allow for field dressing and cutting.

PART II : MATERIAL SELECTION

Thin Veneer

- Stone adhered to wood, metal brick or concrete wall. Stone is 1.0 inch thick and weighs less than 14 pounds per square foot.
- It does not require a supporting masonry shelf and can be used for exterior cladding or interior applications.
- Most projects are installed by experienced stone masons and contractors. We recommend viewing a project portfolio and speaking with references.
- Some customers elect to install this stone as a do-it-yourself (DIY) project.

Building Veneer

- Stone anchored to a concrete masonry shelf—a weight bearing foundation.
- Stone is 3.0-6.0 inches thick and is typically used for exterior cladding applications.
- Building veneer installation is done best in the hands of a skilled craftsman.

PART III : INSTALLATION & FINISH

Applying Paramount Thinstone

- Install a temporary ledge to keep stone off of floor or finished grade. 0.5 inches for interior. 3-4 inches for exterior.
- Apply horizontal chalk lines every 16 inches to keep the courses of stone parallel.
- Start at the bottom of the structure and work up.
- Start with "corners" before "flats."
- Use mason's trowel to apply thin mortar layer to scratch coat where placing stone.
- Butter the back of the stone with a roughly 0.5 inch thick mass of mortar leaving no air pockets.
- Press the buttered stone to surface and hold for a few seconds. Press far enough to ensure mortar oozes out all sides, but leaving a roughly 0.5 inch bed of mortar behind each stone.
- Scrape excess mortar from joints with pointer. Ensure that the mortar has contact with the back and all sides of each stone with no air pockets.
- Once placed, the stone cannot be moved or adjusted. If stone loosens, it must be removed, cleaned and reinstalled.

Filling Joints

- Once stones have been adhered and set for a minimum of 24 hours, you are ready to grout.
- Use a grout bag (Looks like a cake frosting bag) to inject mortar into the joints after the stone has been installed.
- Color can be added to the mortar if desired.

Finishing

- When mortar is firm, thumb print hard, then the joints can be finished.
- Rake joints to reveal the edge of the stones and sweep smooth with a stiff brush. Use care so that the joints are not raked too deep which could loosen the stone.
- An over-grout method can also be used. Fill joints flush to the surface of the stone then smooth with a soft brush.

Cleaning

- If mortar attaches to the face of the stone during installation, let it harden slightly and then brush off with a sponge and bristle brush.
- Stone can be cleaned with a mild detergent, diluted with clean water. Wait 2-3 days before cleaning and test a small area first.
- **Do NOT use metal brushes, they will leave scratch marks.**
- **Do NOT use acid.**

SHOW US YOUR PROJECT!

Photograph your finished project and email it to info@paramountstone.com or post it to our facebook wall [facebook.com/paramountstone](https://www.facebook.com/paramountstone)